



PINNACLE TENTS

Your Source for Tents and Portable Shelters

Pop Up Tent - New Design - Unique 2 Ring Spring Steel Frame



New Spring Steel 2 Rod Design
More Durable 3 Second Tent
Lifetime Frame Warranty

Size	86x59x43H inches; Packed size: 29" diameter x 1.5" H
Roof and Walls, Fly	190T polyester; PU 2000mm; Fire Resistant CPAI-84; UPF50+; all seams taped
Floor	210D Oxford Polyester PU1500mm - Floor/wall interface seam taped
Screening	Fine mesh no-see-um
Pole Sleeves	150D Oxford polyester PU2000mm
Frame	Spring steel zinc plated 2xdia.4mm round steel poles with flexible PVC sleeve covering and 1x7.9mm straight fiberglass for rain fly
Accessories	8 steel stakes, 4 guy ropes
Packaging	Individually boxed or case packed
Pieces Per Carton	6
Carton Size	Size: 29x29x9H inches - volume 0.115m3 (4.4cu-ft)
Net Weight	5 Pounds
Additional Features	Inside storage pockets (1); Hanging loop; Guy rope attach loops (4); Carry Bag

Pop Up Tent - Model XPP60-2
Sleeps 2

Pinnacle Tents
4022 E. Greenway Road
Suite 11-153
Phoenix, AZ 85032

Phone: 877-379-8269
Fax: 877-379-8269
E-mail: sales@pinnacletents.com

PINNACLE TENTS

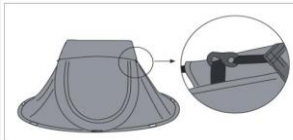
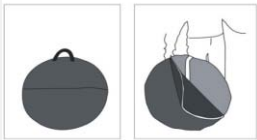

SETTING UP YOUR SELF-ERECTING TENT:

Take the tent out of the bag, remove the strap and release the tent away from you with a spin to self erect. CAUTION: STEP BACK TO AVOID CONTACT WITH THE TENT AS IT ERECTS.

Stake the tent down at the four corners by securing the stakes to the base ring. The following 2 steps are only necessary if you attach the rain cap. Place the fiberglass rod across the top and insert it into the grommet at each end.

Attach the hooks on the rain cap to the corresponding loops on the tent. If you wish, you can attach guy ropes to the loops on the four corners to increase stability in the wind.

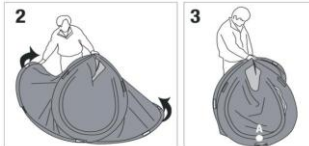
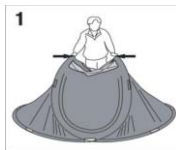

FOLDING AND STORING TENT:

To dismantle, remove stakes. Unzip door.

Form a "taco" shape by gathering top and base edges together at center.

Lift the tent up, with one hand grasp the top and base at the center, with the other hand push the edge labeled A down toward the ground.

Tuck back the top most edge labeled A (see arrow) down and inward until it forms ring shapes on ground.

Slide rings over the top of each other and adjust rings to lie on top of one another.

When all rings are together, secure tent between legs and slide strap over rings to hold them together. Slide tent into bag. Then place accessories into bag to store.